

ORGP1002 REED SWITCH

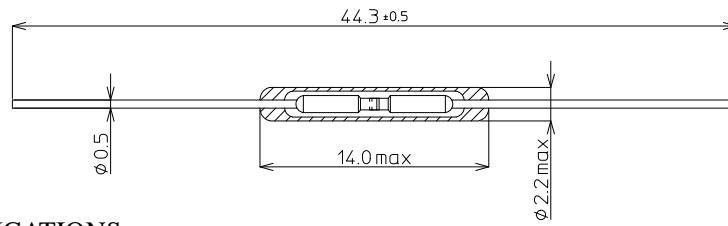

. SPECIFICATIONS

1-1. Electrical characteristics

1. Pull-in	10 ~ 30	AT	
2. Drop-out	4	AT	min
3. Contact resistance	100	m	max
4. Breakdown voltage	220	DCV	min
5. Insulation resistance	10^{10}		min
6. Electrostatic capacitance	0.35	pF	max
7. Contact rating	10	W, VA	
8. Maximum switching voltage	100	DCV	
9. Maximum switching current	0.5	A	
10. Maximum carry current	1.0	A	

1-2. Operating characteristics

1. Operate time	0.4	ms	max
2. Bounce time	0.3	ms	max
3. Release time	0.05	ms	max
4. Resonant frequency	5000 ± 600	Hz	
5. Maximum operating frequency	500	Hz	

1-3. Environmental characteristics

1. Shock	980(100G)	m/s^2	(6ms)
2. Vibration	196(20G)	m/s^2	(10 ~ 2000Hz)
3. Temperature range	-40 ~ +125		
4. Lead tensile strength	29.4(3kgf)	N	

. STRUCTURE AND DIMENSIONS

1. Contact arrangement	Form A		
2. Contact material	Noble Metal		
3. Glass diameter	2.20	mm	max
4. Glass length	14.0	mm	max
5. Overall length	44.3 ± 0.5	mm	

			OKI SENSOR DEVICE CORPORATION	
			NOMENCLATURE	
			ORGP1002 REED SWITCH	
			REFERENCE	DRAWING NO.