

REED SWITCH MYK1A-1

CONTACT FORM A NORMALLY OPEN CONTACTS

Switching current 0,5 A

Switching power 15 W, VA

Switching voltage 160 V

Pull in range 20...75 AT

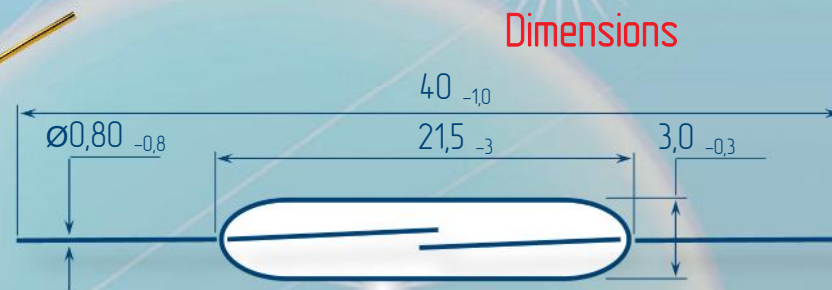

Electrical Data

Release range, AT, min	6
Carry current, A	0,5
Breakdown voltage	
V, not less, AC/DC	127/180
Resetting Ratio	0,3...0,9
Contact resistance, Ω , not more	0,15
Operating time including bounce, ms, not more	1
Release time including bounce ms, not more	0,3
Capacitance, pF, not more	0,4
Insulation resistance, G Ω , not less	1
Operating frequency, Hz	100
Switching current frequency, kHz, not more	10

Environmental Data

Contact material	Ru
Life expectancy, switching cycles $\times 10^6$ max load power... low load power	0,002...10
Vibration (1...600 Hz), g, not more	10
Resonant frequency, Hz	2400
Shock (1 \pm 0,3) ms, g, not more	150
Weight, g, not more	0,40
Operating temperature, $^{\circ}\text{C}$	-60...125
Humidity, %, not more	98

Certificates



Test Coil

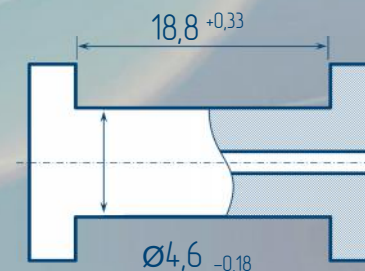

5000 turns, wire $\varnothing 0,063$ mm
coil resistance 550

Order information

Delivery of reed switches with formed and/or cropped leads and with narrow pull in ranges is available by agreements.



RYAZAN METAL CERAMICS INSTRUMENTATION PLANT, JSC
51V, Novaya St., 390027, Ryazan, Russia
Phone: +7 (4912) 240-234, Факс: +7 (4912) 240-234 E-mail: ives@rmcip.ru

Update on 19 November 2013

