

# REED SWITCH MKA-50202

## CONTACT FORM A NORMALLY OPEN CONTACTS

Switching current 5 A

Switching power 250 W, VA

Switching voltage 250 V

Pull in range 40...100 AT

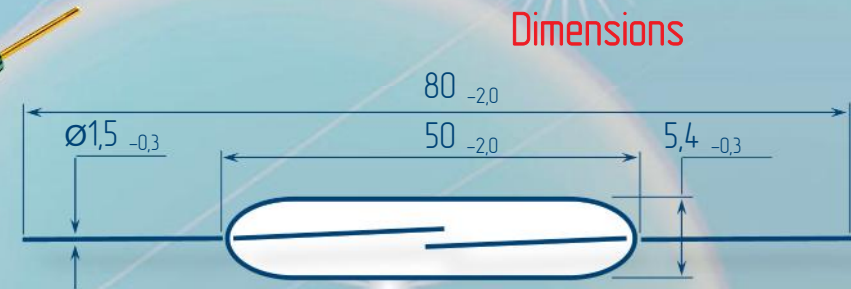
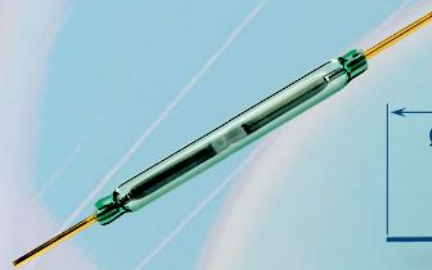

### Electrical Data

Release range, AT, min	16
Carry current, A	5
Breakdown voltage, V, not less, AC/DC	less 50 A more 50 A 360/500 500/700
Resetting Ratio	0,4...0,9
Contact resistance, Ω, not more	0,15
Operating time including bounce, ms, not more	2
Release time including bounce ms, not more	1
Capacitance, pF, not more	1
Insulation resistance, GΩ, not less	1
Operating frequency, Hz	25
Switching current frequency, kHz, not more	10

### Environmental Data

Contact material	Mo
Life expectancy, switching cycles x10 <sup>6</sup> max load power... low load power	0,005...2
Vibration (1...500 Hz), g, not more	10
Resonant frequency, Hz	700
Shock (1±0,3) ms, g, not more	150
Weight, g, not more	2,0
Operating temperature, °C	-60...100
Humidity, %, not more	98

### Certificates



### Test Coil

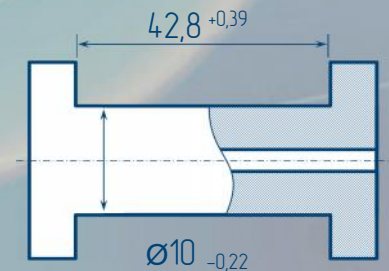

5000 turns, wire Ø0,112 mm  
coil resistance 335

### Order information

Delivery of reed switches with formed and/or cropped leads and with narrow pull in ranges is available by agreements.



RYAZAN METAL CERAMICS INSTRUMENTATION PLANT, JSC  
51V, Novaya St., 390027, Ryazan, Russia  
Phone: +7 (4912) 240-234, Факс: +7 (4912) 240-234 E-mail: ives@rmcip.ru

Update on 19 November 2013

