

REED SWITCH MKA-16101

CONTACT FORM A NORMALLY OPEN CONTACTS

x

Switching current 0,5 A

Switching power 10 W, VA

Switching voltage 100 V

Pull in range 10...50 AT

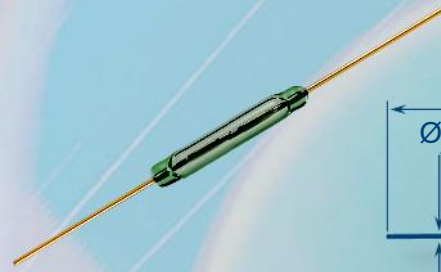

Dimensions

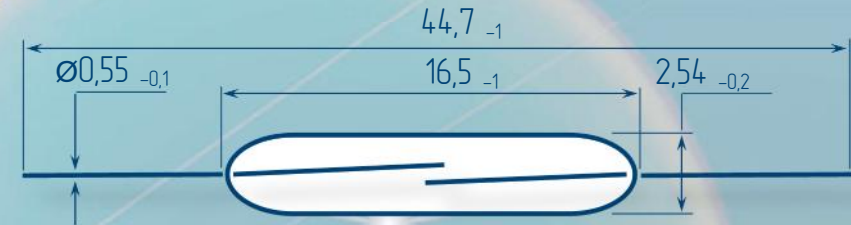

Electrical Data

Release range, AT, min	5
Carry current, A	0,5
Breakdown voltage	
V, not less, AC/DC	160/220
Resetting Ratio	0,35...0,95
Contact resistance, Ω, not more	0,1
Operating time including bounce, ms, not more	0,6
Release time including bounce ms, not more	0,4
Capacitance, pF, not more	0,3
Insulation resistance, GΩ, not less	1
Operating frequency, Hz	400
Switching current frequency, kHz, not more	10

Environmental Data

Contact material	Ru
Life expectancy, switching cycles x10 ⁶ max load power... low load power	0,1...100
Vibration (1...2000 Hz), g, not more	10
Resonant frequency, Hz	3000
Shock (1±0,3) ms, g, not more	150
Weight, g, not more	0,16
Operating temperature, °C	-60...125
Humidity, %, not more	98

Certificates



Test Coil

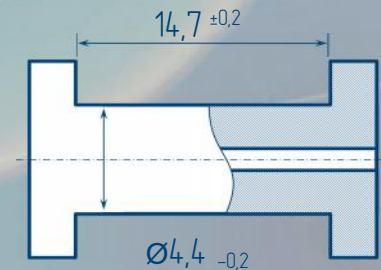

5000 turns, wire Ø0,063 mm
coil resistance 620

Order information

Delivery of reed switches with formed and/or cropped leads and with narrow pull in ranges is available by agreements.



RYAZAN METAL CERAMICS INSTRUMENTATION PLANT, JSC
51V, Novaya St., 390027, Ryazan, Russia
Phone: +7 (4912) 240-234, Факс: +7 (4912) 240-234 E-mail: ives@rmcip.ru

Update on 19 November 2013

