

# REED SWITCH MKA-14106

# CONTACT FORM A NORMALLY OPEN CONTACTS

Reed relays, Security, Limit switching, Telecoms, Office equipment

Switching current 0,5 A

Switching power 10 W, VA

Switching voltage 100 V

Pull in range 10...35 AT

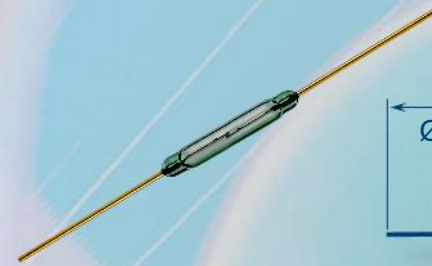

## Electrical Data

Release range, AT, min	7
Carry current, A	0,5
Breakdown voltage	
V, not less, AC/DC	160/220
Resetting Ratio	0,7...0,95
Contact resistance, $\Omega$ , not more	0,14
Operating time including bounce, ms, not more	1
Release time including bounce ms, not more	0,4
Capacitance, pF, not more	0,7
Insulation resistance, G $\Omega$ , not less	10
Operating frequency, Hz	100
Switching current frequency, kHz, not more	10

## Environmental Data

Contact material	Ru
Life expectancy, switching cycles x10 <sup>6</sup> max load power... low load power	0,5...100
Vibration (1...2000 Hz), g, not more	20
Resonant frequency, Hz	4000
Shock (1±0,3) ms, g, not more	150
Weight, g, not more	0,14
Operating temperature, °C	-60...155
Humidity, %, not more	98

## Certificates



## Test Coil

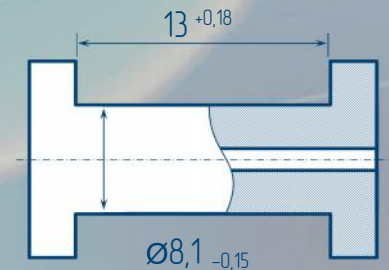

5000 turns, wire  $\varnothing 0,063$  mm  
coil resistance 870

## Order information

Delivery of reed switches with formed and/or cropped leads and with narrow pull in ranges is available by agreements.



RYAZAN METAL CERAMICS INSTRUMENTATION PLANT, JSC  
51V, Novaya St., 390027, Ryazan, Russia  
Phone: +7 (4912) 240-234, Факс: +7 (4912) 240-234 E-mail: ives@rmcip.ru

Update on 19 November 2013

