

REED SWITCH CONTACT FORM A NORMALLY OPEN CONTACTS

MKA-14103

Reed relays, Security, Limit switching, Telecoms, Office equipment (up to 10kHz)

Switching current 1 A

Switching power 10 W, VA

Switching voltage 200 V

Pull in range 8...35 AT

Electrical Data

Release range, AT, min	4
Carry current, A	1
Breakdown voltage	less 15 A more 15 A
V, not less, AC/DC	160/220 180/250
Resetting Ratio	0,35...0,9
Contact resistance, Ω , not more	0,1
Operating time including bounce, ms, not more	1
Release time including bounce ms, not more	0,4
Capacitance, pF, not more	0,7
Insulation resistance, G Ω , not less	10
Operating frequency, Hz	100
Switching current frequency, kHz, not more	10

Environmental Data

Contact material	Ru
Life expectancy, switching cycles $\times 10^6$ max load power... low load power	0,1...100
Vibration (1...2000 Hz), g, not more	40
Resonant frequency, Hz	4000
Shock (1 \pm 0,3) ms, g, not more	150
Weight, g, not more	0,14
Operating temperature, $^{\circ}\text{C}$	-60...155
Humidity, %, not more	98

Order information

Delivery of reed switches with formed and/or cropped leads and with narrow pull in ranges is available by agreements.

Dimensions



Certificates



Test Coil

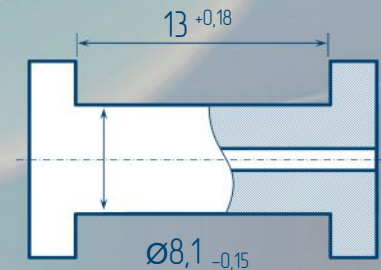

5000 turns, wire $\varnothing 0,063$ mm
coil resistance 870



RYAZAN METAL CERAMICS INSTRUMENTATION PLANT, JSC
51V, Novaya St., 390027, Ryazan, Russia
Phone: +7(4912) 240-234, Fax: +7(4912) 240-234 E-mail: ives@rmcip.ru

Update on 29 April 2015

